

Figur 1F

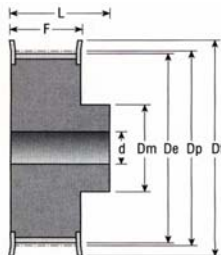

Figur 6F

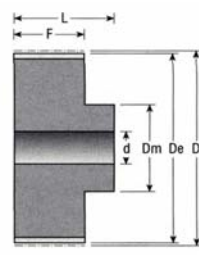

Figur 6



Typ ' M - Pro řemeny HTD ' M (resp. ' RPP) - rozteč 3,0mm / For belts HTD 3M (3RPP) - Pitch 3,0mm

Zubů Teeth	Šíř.ř. Width	Označení / Obj.č. Part.No.	Typ Fig.	* Mat.	Dp [mm]	De [mm]	Df [mm]	Dm [mm]	Di [mm]	F [mm]	L [mm]	d [mm]	m [kg]
10	9	10-03M-09	1F	AL	9,55	8,79	13,00	13,00	-	10,2	17,5	-	0,004
	15	10-03M-15	1F	AL	9,55	8,79	13,00	13,00	-	17,0	26,0	-	0,006
12	9	12-03M-09	1F	AL	11,46	10,70	15,00	15,00	-	10,2	17,5	-	0,006
	15	12-03M-15	1F	AL	11,46	10,70	15,00	15,00	-	17,0	26,0	-	0,008
14	9	14-03M-09	1F	AL	13,37	12,61	16,00	16,00	-	10,2	17,5	-	0,007
	15	14-03M-15	1F	AL	13,37	12,61	16,00	16,00	-	17,0	26,0	-	0,010
15	9	15-03M-09	1F	AL	14,32	13,56	17,50	17,50	-	10,2	17,5	-	0,008
	15	15-03M-15	1F	AL	14,32	13,56	17,50	17,50	-	17,0	26,0	-	0,012
16	9	16-03M-09	6F	AL	15,28	14,52	18,00	9,50	-	12,8	20,6	4,0	0,007
	15	16-03M-15	6F	AL	15,28	14,52	18,00	9,50	-	19,5	26,0	4,0	0,010
18	9	18-03M-09	6F	AL	17,19	16,43	19,50	10,00	-	12,8	20,6	6,0	0,008
	15	18-03M-15	6F	AL	17,19	16,43	19,50	10,00	-	19,5	26,0	6,0	0,012
20	9	20-03M-09	6F	AL	19,10	18,34	23,00	12,00	-	12,8	20,6	6,0	0,010
	15	20-03M-15	6F	AL	19,10	18,34	23,00	12,00	-	19,5	26,0	6,0	0,014
21	9	21-03M-09	6F	AL	20,05	19,29	25,00	13,00	-	12,8	20,6	6,0	0,013
	15	21-03M-15	6F	AL	20,05	19,29	25,00	13,00	-	19,5	26,0	6,0	0,016
22	9	22-03M-09	6F	AL	21,01	20,25	25,00	13,00	-	12,8	20,6	6,0	0,014
	15	22-03M-15	6F	AL	21,01	20,25	25,00	13,00	-	19,5	26,0	6,0	0,018
24	9	24-03M-09	6F	AL	22,92	22,16	25,00	13,00	-	12,8	20,6	6,0	0,016
	15	24-03M-15	6F	AL	22,92	22,16	25,00	13,00	-	19,5	26,0	6,0	0,020
26	9	26-03M-09	6F	AL	24,83	24,07	28,00	16,00	-	12,8	20,6	6,0	0,018
	15	26-03M-15	6F	AL	24,83	24,07	28,00	16,00	-	19,5	26,0	6,0	0,027
28	9	28-03M-09	6F	AL	26,74	25,98	32,00	18,00	-	12,8	20,6	6,0	0,024
	15	28-03M-15	6F	AL	26,74	25,98	32,00	18,00	-	19,5	26,0	6,0	0,030
30	9	30-03M-09	6F	AL	28,65	27,89	32,00	19,00	-	12,8	20,6	6,0	0,028
	15	30-03M-15	6F	AL	28,65	27,89	32,00	19,00	-	19,5	26,0	6,0	0,035
32	9	32-03M-09	6F	AL	30,56	29,80	36,00	22,00	-	12,8	20,6	6,0	0,032
	15	32-03M-15	6F	AL	30,56	29,80	36,00	22,00	-	19,5	26,0	6,0	0,042
36	9	36-03M-09	6F	AL	34,38	33,62	38,00	26,00	-	13,4	22,2	6,0	0,045
	15	36-03M-15	6F	AL	34,38	33,62	38,00	26,00	-	20,0	30,0	6,0	0,060
40	9	40-03M-09	6F	AL	38,20	37,44	42,00	28,00	-	13,4	22,2	6,0	0,055
	15	40-03M-15	6F	AL	38,20	37,44	42,00	28,00	-	20,0	30,0	6,0	0,075
44	9	44-03M-09	6F	AL	42,02	41,26	48,00	33,00	-	13,4	22,2	6,0	0,074
	15	44-03M-15	6F	AL	42,02	41,26	48,00	33,00	-	20,0	30,0	6,0	0,100
48	9	48-03M-09	6	AL	45,84	45,08	-	33,00	-	13,4	22,2	8,0	0,074
	15	48-03M-15	6	AL	45,84	45,08	-	33,00	-	20,0	30,0	8,0	0,103
60	9	60-03M-09	6	AL	57,30	56,54	-	33,00	-	13,4	22,2	8,0	0,106
	15	60-03M-15	6	AL	57,30	56,54	-	33,00	-	20,0	30,0	8,0	0,150
72	9	72-03M-09	6	AL	68,75	67,99	-	33,00	-	13,4	22,2	8,0	0,145
	15	72-03M-15	6	AL	68,75	67,99	-	33,00	-	20,0	30,0	8,0	0,212

* Materiál: AL = slitina hliníku / AL = Aluminium